

Wall Mounting Brackets

Wall mounting bracket kit for Moduline MWM Series enclosures and JB Series junction boxes.

Material: DIN EN 10130 DC01 CCRS

Surface Finishing: Zinc coated Cr⁺³ passivation

Thickness: 2mm

Pieces supplied: 4 brackets per packet

Weight per packet: 0.16kg

Supplied with: Wall mounting screws

Product images



Product dimensions and details

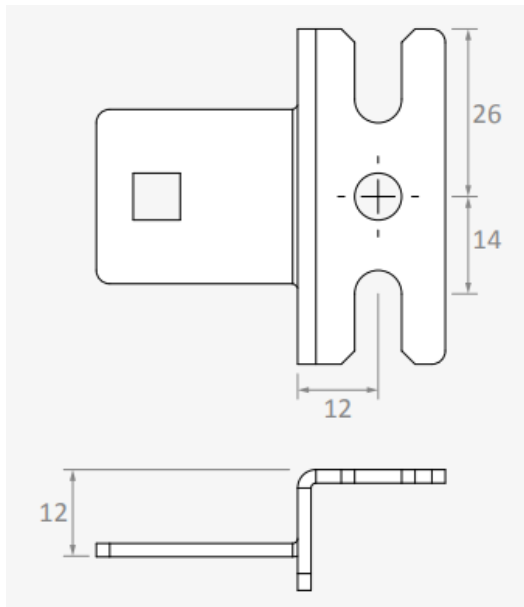

Part No.	Detail	Pieces
MBWB	Wall mounting bracket kit with mounting screws	4

Subject to change without notice