

Pre-Insulated Fork Terminals - Single Conductor Grip Range

Specifications

- Conductor Material: Copper
- Treatment: Tin plating
- Insulation Material: Vinyl
- Maximum electrical rating: 105°C 600 volts
- Packet quantity: 100pc

Product Images



Product Details and Dimensions

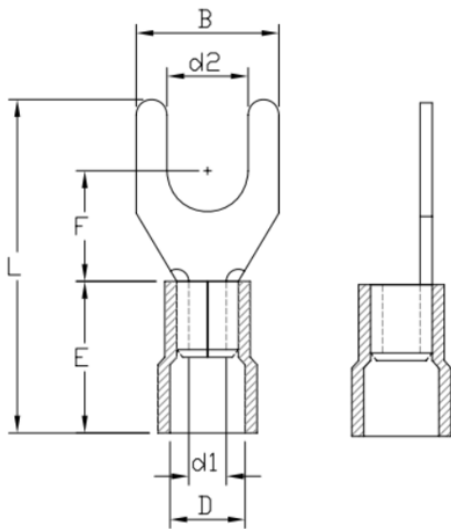

Red

Part No:	Colour	Wire Range (mm ²)	AWG	d2	B	F	L	E	D	d1
IF1-3.5	Red	0.5 – 1.5	22 - 16	3.7	6.4	6.3	20.6	10.0	4.1	1.7
IF1-4	Red	0.5 – 1.5	22 - 16	4.3	7.2	6.3	21.0	10.0	4.1	1.7
IF1-5	Red	0.5 – 1.5	22 - 16	5.3	9.5	7.0	21.0	10.0	4.1	1.7
IF1-6	Red	0.5 – 1.5	22 - 16	6.5	12.0	11.1	27.2	10.0	4.1	1.7

Measurements are in mm

Blue

Part No:	Colour	Wire Range (mm ²)	AWG	d2	B	F	L	E	D	d1
IF2-3	Blue	1.5 – 2.5	16 - 14	3.2	5.8	6.3	21.0	10.0	4.5	2.3
IF2-3.5	Blue	1.5 – 2.5	16 - 14	3.7	6.4	6.3	21.0	10.0	4.5	2.3
IF2-4	Blue	1.5 – 2.5	16 - 14	4.3	7.2	6.5	21.2	10.0	4.5	2.3
IF2-5	Blue	1.5 – 2.5	16 - 14	5.3	9.5	7.3	22.0	10.0	4.5	2.3
IF2-6	Blue	1.5 – 2.5	16 - 14	6.5	12.0	11.0	27.2	10.0	4.5	2.3

Measurements are in mm

Yellow

Part No:	Colour	Wire Range (mm ²)	AWG	d2	B	F	L	E	D	d1
IF5-3.5	Yellow	4.0 – 6.0	12 - 10	3.7	8.5	7.5	25.7	13.0	6.5	3.4
IF5-4	Yellow	4.0 – 6.0	12 - 10	4.3	9.5	7.5	25.7	13.0	6.5	3.4
IF5-5	Yellow	4.0 – 6.0	12 - 10	5.3	9.5	7.5	25.7	13.0	6.5	3.4
IF5-6	Yellow	4.0 – 6.0	12 - 10	6.5	12.0	12.0	31.7	13.0	6.5	3.4

Measurements are in mm

Maximum Electric Current

AWG	22	20	18	16	14	12	10
Max Amp	9	12	17	18	30	35	50

Colour	Red	Blue	Yellow
Wire Range (mm ²)	0.5 - 1.5	1.0 - 2.5	4.0 - 6.0
Fork Terminals	9 - 18 A	18 - 30 A	35 - 50 A

Subject to change without notice