

Pre-Insulated Bullet Connectors - Female

Specifications

- Conductor Material: Brass
- Treatment: Tin plating
- Insulation Material: Vinyl
- Maximum electrical rating: 75°C 300 volts
- Packet quantity: 100pc

Product Images



Product Details and Dimensions

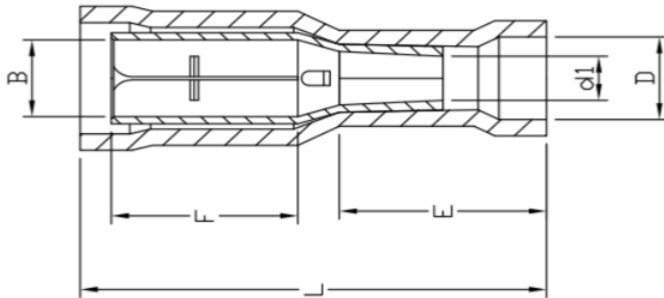

Part No:	Colour	Wire Range (mm ²)	AWG	B	F	L	E	D	d1	Material thickness
BCF1-4	Red	0.5 – 1.5	22 - 16	4.0	9.0	23.0	10.0	4.0	1.7	0.4 +/-5%
BCF2-5	Blue	1.5 – 2.5	16 – 14	5.0	9.0	23.5	10.0	4.5	2.3	0.4 +/-5%
BCF5-5	Yellow	4.0 – 6.0	12 - 10	5.0	9.0	24.5	13.0	5.5	3.4	0.4 +/-5%

Measurements are in mm

MAXIMUM ELECTRIC CURRENT

A. W. G	22	20	18	16	14	12	10
MAX AMP	3	4	7	10	15	20	24

Colour	Red	Blue	Yellow
Wire Range (mm ²)	0.5 - 1.5	1.0 - 2.5	4.0 - 6.0
Bullet Connectors	3 - 10 A	10 - 15 A	20 - 24 A

Subject to change without notice