

MWM Series - Plinths



Material:	Steel – powder coated
Colour:	Black

Product details

Part No.	Colour	Width X	Depth Y
MPL6.2	Black	600	200
MPL6.3	Black	600	300
MPL8.2	Black	800	200
MPL8.3	Black	800	300
MPL10.3	Black	1000	300
MPL12.3	Black	1200	300

Measurements are in mm

Product dimensions and images

Isometric view

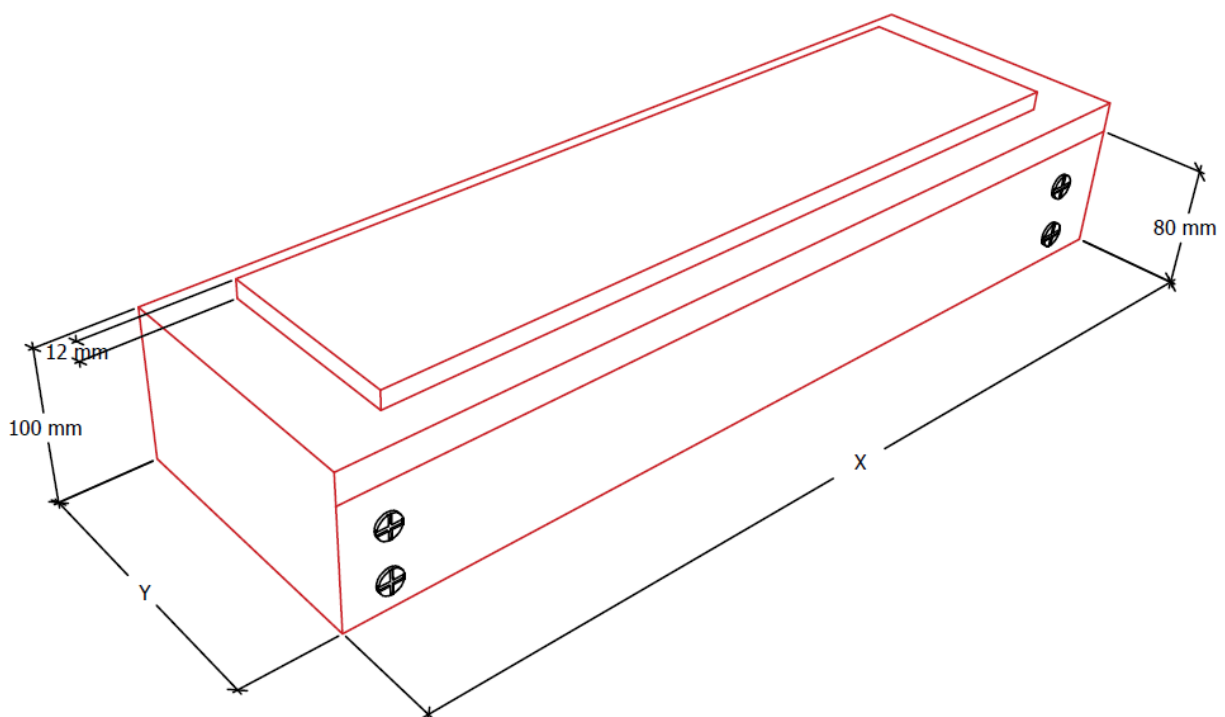

Plan view

MPL6.2

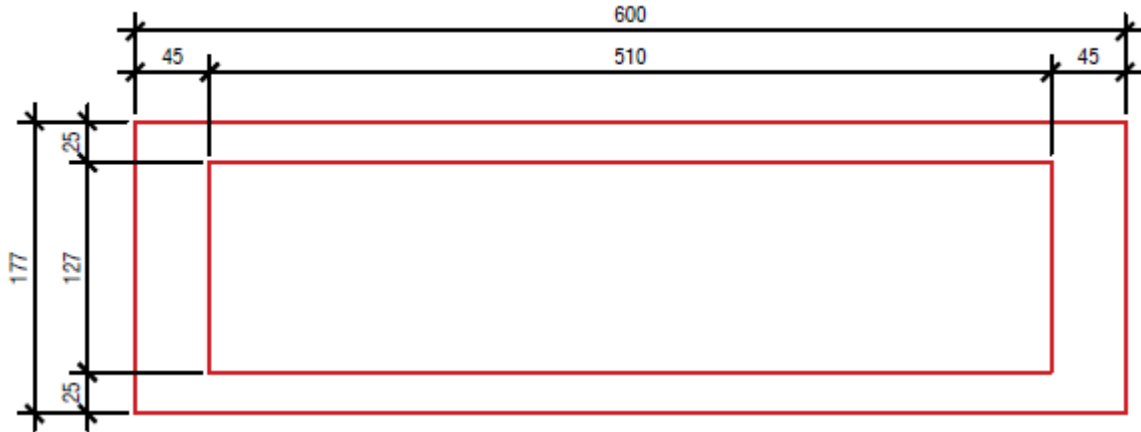

MPL6.3

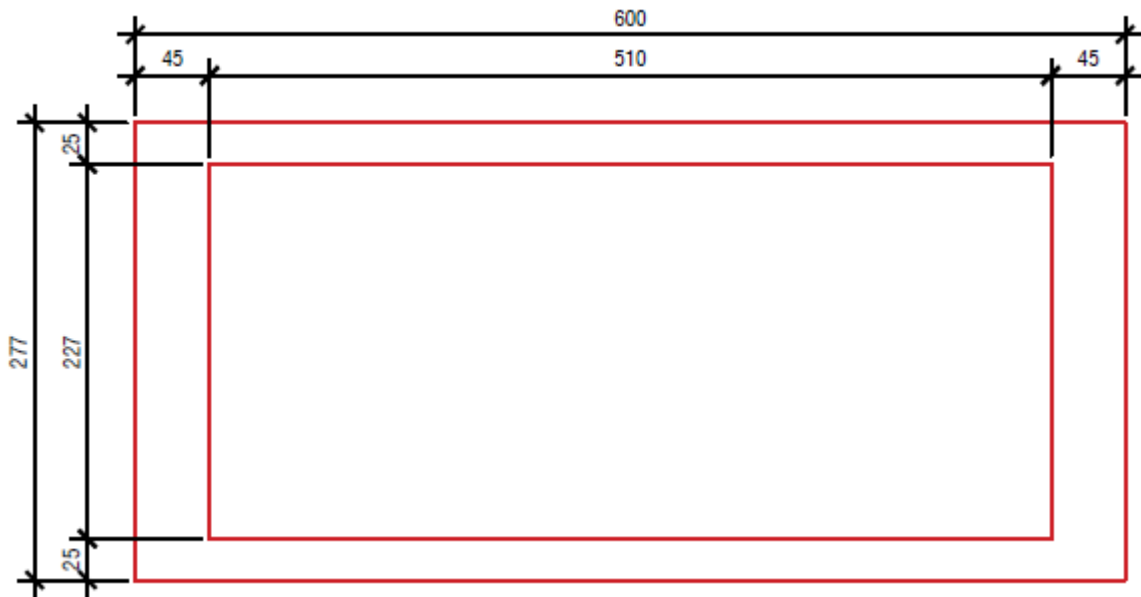

MPL8.2

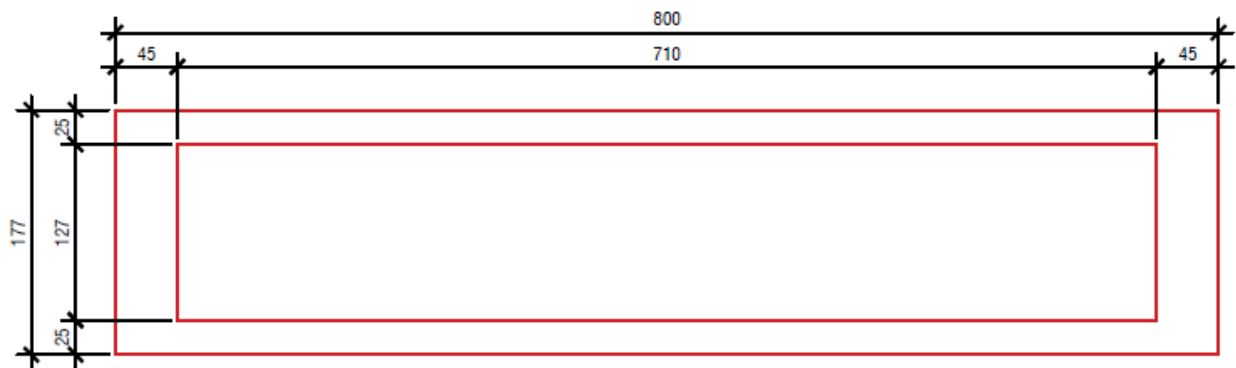

MPL8.3

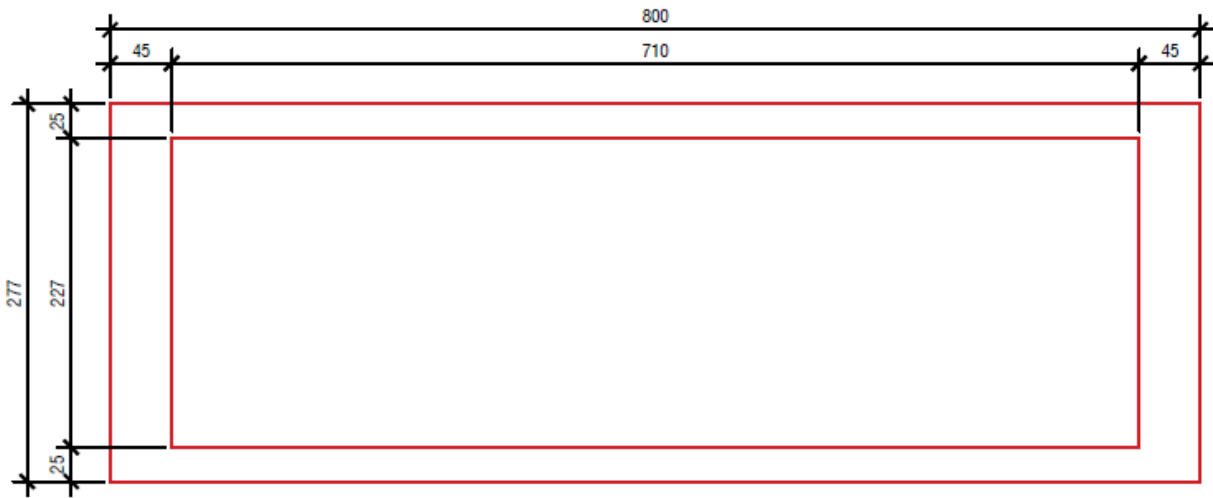

MPL10.3

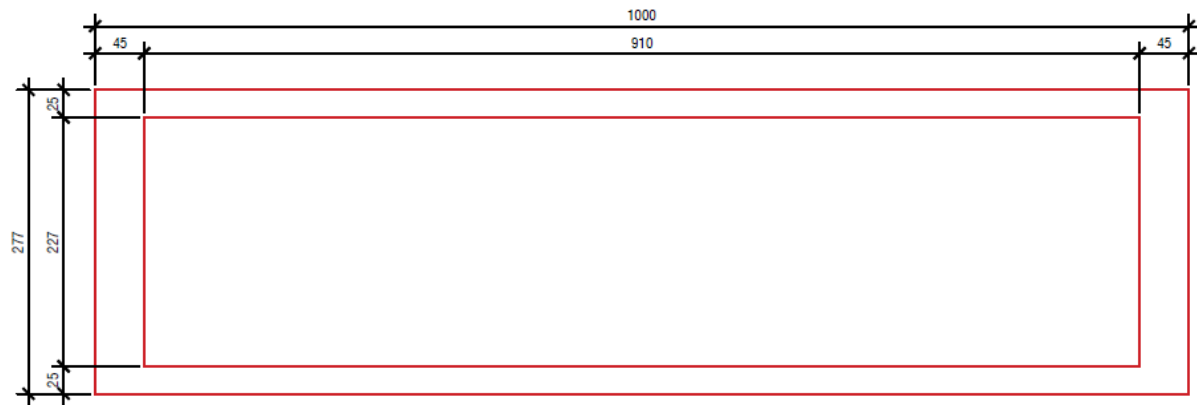

MPL12.3

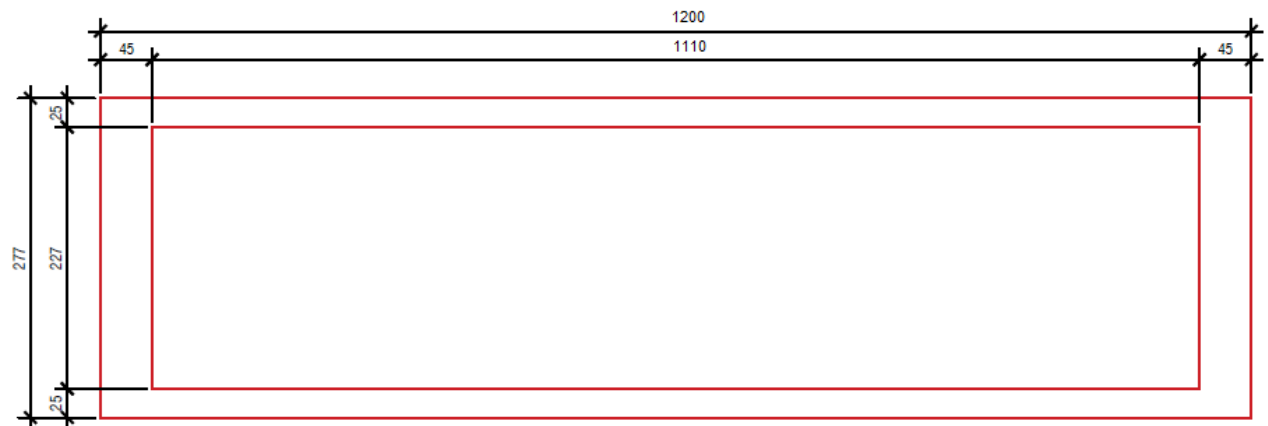

Subject to change without notice