

Cam Switches – DIN Mount

Product Details

Part No.	Position	Type	Detail	Label Position
CSDIN101M	3 Position	Maintained	Changeover (AUTO, OFF, MANUAL)	(60 DEG) (10-0-2)
CSDIN101S	3 Position	Spring Return	Changeover (RESET, STANDBY, TEST)	(45 DEG) (10:30-0-1:30)
CSDIN11M	2 Position	Maintained	Changeover (AUTO, MANUAL)	(60 DEG) (10-2)
CSDIN10M	2 Position	Maintained	With Off (OFF, ON)	(60 DEG) (0-2)
CSDIN11S	2 Position	Spring Return	Changeover (AUTO, MANUAL)	(45 DEG) (0-1:30)

* 2 position labels (CS22-ENGPLA-2P) are available as accessories in 5 options:
 1. OFF/ON 2. ON/OFF 3. AUTO/OFF 4. OFF/AUTO 5. AUTO/MAN

Product Images



Technical Specifications

Specification		
Rated insulation voltage	U _i V	660/690
Rated thermal current	I _{th} A	20
Rated working voltage	U _e V	24-110 240 440
Rated working current	I _e	
AC-21A AC-22A	A	20 20
AC-23A	A	15 15
AC-2	A	15 15
AC-3	A	11 11
AC-4	A	3.5 3.5
AC-15	A	5 4
DC-13	A	120.4 0.4
Power	P	
AC-23A	KW	3.7/2.5 7.5/3.7
AC-2	KW	4 7.5
AC-3	KW	3/2.2 5.5/3
AC-4	KW	0.55/0.75 1.5/1.5

AC Duty Rating	
Category	Typical AC Application
AC-1	Non-Inductive or slightly Inductive Loads, Resistance Furnaces
AC-2	Wound-Rotor Motors: starting switching off motors
AC-3	Squirrel Cage Motors: starting switching off motors during running
AC-4	Squirrel Cage motors: starting, plug braking or reverse motion jog running
AC-15	Control of AC electromagnetic loads
AC-21A	Switching of resistive loads, including moderate overloads (frequent switching)
AC-23-A	Switching of motor loads or other highly inductive loads (frequent switching)

Re2: The power under: AC-23A, AC-3, AC-4 are in three phase three poles, and the denominator represents the power under single phase two poles.

Mechanical Life

Without load:	0.1 x 10 ⁶ times, operation frequency is 120 times/h
With load:	0.03 x 10 ⁶ times, operation frequency is 120 times/h

Product Dimensions

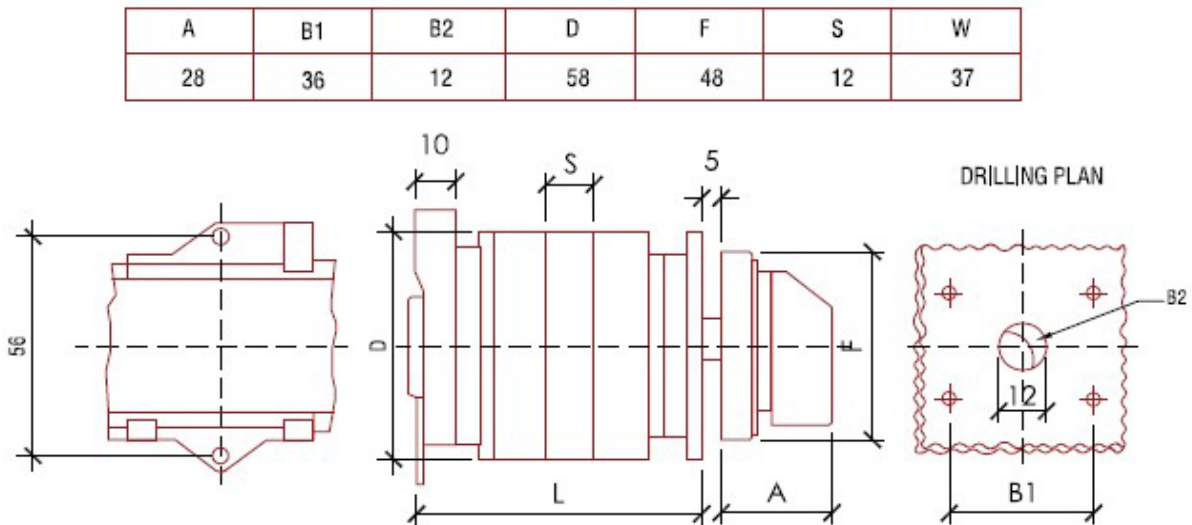

Dimensions are in mm

Connecting Diagrams

3 POSITION

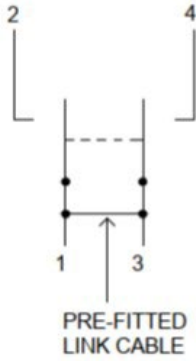

2 POSITION
WITHOUT OFF

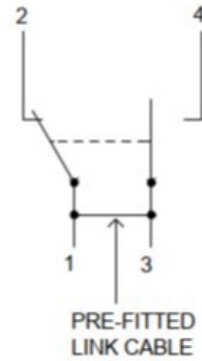

2 POSITION
WITH OFF



Subject to change without notice